

Aluminum Cable Tray

U-Style Fittings Horizontal Reducing Tee

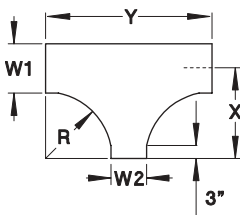
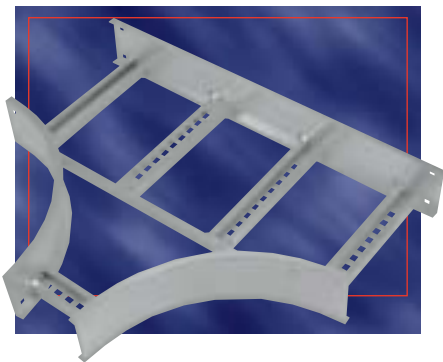

Part Numbering System

AUF-7-36-24-L-RT12

Fitting Material and Siderail | Width 1 | Bottom Style | Fitting Type | Nominal Radius
Siderail Depth | Width 2

Selection Guide

Tray Widths W1: **36, 30, 24, 18, 12, 9**
 Tray Widths W2: **30, 24, 18, 12, 9, 6**
 Nominal Radius: **12, 24, 36, 48**
 Bottom Styles: **L**- Ladder, **V**- Ventilated, **S**- Solid
 Side Rail Depth: **4"- 7"**

Technical Specifications

Horizontal REDUCING TEE – U-Style

Widths		Catalogue Number	(+ 12" Nominal Radius)		(+ 24" Nominal Radius)		(+ 36" Nominal Radius)		(+ 48" Nominal Radius)	
W1	W2		X	Y	X	Y	X	Y	X	Y
36	30	AUF(+)-3630-(*)-RT(+)	30	54	42	78	54	102	66	126
	24	AUF(+)-3624-(*)-RT(+)	30	48	42	72	54	96	66	120
	18	AUF(+)-3618-(*)-RT(+)	30	42	42	66	54	90	66	114
	12	AUF(+)-3612-(*)-RT(+)	30	36	42	60	54	84	66	108
	9	AUF(+)-3609-(*)-RT(+)	30	33	42	57	54	81	66	105
	6	AUF(+)-3606-(*)-RT(+)	30	30	42	54	54	78	66	102
30	24	AUF(+)-3024-(*)-RT(+)	27	48	39	72	51	96	63	120
	18	AUF(+)-3018-(*)-RT(+)	27	42	39	66	51	90	63	114
	12	AUF(+)-3012-(*)-RT(+)	27	36	39	60	51	84	63	108
	9	AUF(+)-3009-(*)-RT(+)	27	33	39	57	51	81	63	105
	6	AUF(+)-3006-(*)-RT(+)	27	30	39	54	51	78	63	102
24	18	AUF(+)-2418-(*)-RT(+)	24	42	36	66	48	90	60	114
	12	AUF(+)-2412-(*)-RT(+)	24	36	36	60	48	84	60	108
	9	AUF(+)-2409-(*)-RT(+)	24	33	36	57	48	81	60	105
	6	AUF(+)-2406-(*)-RT(+)	24	30	36	54	48	78	60	102
18	12	AUF(+)-1812-(*)-RT(+)	21	36	33	60	45	84	57	108
	9	AUF(+)-1809-(*)-RT(+)	21	33	33	57	45	81	57	105
	6	AUF(+)-1806-(*)-RT(+)	21	30	33	54	45	78	57	102
12	9	AUF(+)-1209-(*)-RT(+)	18	33	30	57	42	81	54	105
	6	AUF(+)-1206-(*)-RT(+)	18	30	30	54	42	78	54	102
9	6	AUF(+)-0906-(*)-RT(+)	16-1/2	30	28-1/2	54	40-1/2	78	52-1/2	102

(†) Insert side rail depth. (*) Insert bottom style to complete Catalogue Number. (+) Insert radius (12" - 48"). Includes 2 pairs of splice plates with hardware.

T&B aluminum cable tray is composed of two distinct systems H-Style and U-Style. These systems are interchangeable.